



Kirby Morgan Dive Systems, Inc.®

1430 Jason Way Santa Maria, California 93455

Phone: 805/928-7772 Fax: 805/928-0342

www.KirbyMorgan.com email: kmdsi@KirbyMorgan.com

INSTRUCTIONS FOR PARTS # 505-055/505-008 SL-17 Neck Clamp & Yoke Assemblies

Neck Clamp Assembly Adjustment

Tools Required:

7/16 inch open end wrench

This neck clamp assembly (7) **MUST BE** adjusted prior to use on a helmet. The clamp assembly will also periodically need adjustment as the neck dam ages and grows thinner. Installation of a new neck dam will also require neck clamp adjustment.

Adjustments must be made with the yoke/neck clamp assembly separated from the helmet, but must be tested on the helmet.

1) Adjustment of the neck clamp when using the old neck dam is done by loosening nut (4), tightening nut (6) until proper tension is achieved when neck clamp assembly is mated to the helmet, then tightening nut (4). When adjusting for a new neck dam, back off nut (6), then re-tighten until proper tension is achieved, then tighten nut (4).

2) The outer nut (6) has a nylon insert. This nut

should periodically be replaced when it is no longer tight on the neck clamp stud.

3) When the neck clamp assembly is correctly adjusted, the clamp should fit tight at the middle of its travel when mated to the helmet shell. Once the lever is past the mid-line, movement of the lever should be easy. From the closed position, the diver should be able to pull the lever open about an inch and when released the lever should snap closed.

4) Proper adjustment of the neck clamp (7) places the bail of the neck clamp squarely in the groove of the latch catch body (19) when the clamp is closed.

5) If the neck clamp binds and does not close correctly after adjustment, the neck clamp must be straightened. To help ensure the proper action of the clamp, this must be done by the KMDSI factory or an authorized service center.

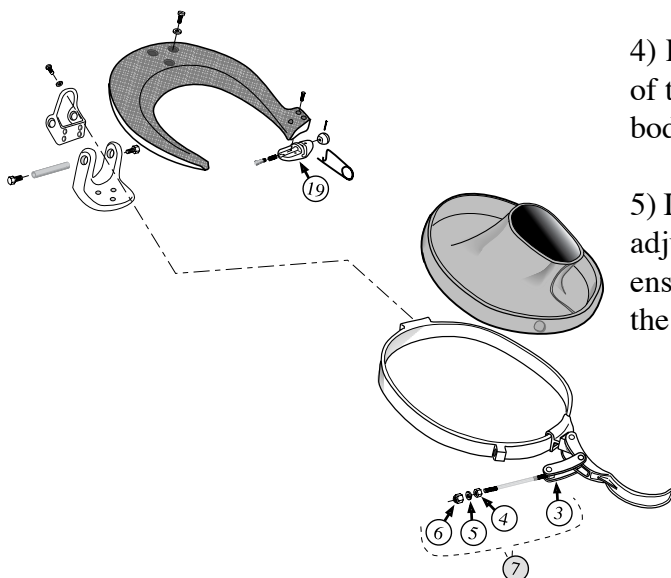

KIRBY MORGAN®
Genuine Parts

Kirby Morgan Dive Systems, Inc.®

1430 Jason Way Santa Maria, California 93455

Phone: 805/928-7772 Fax: 805/928-0342

www.KirbyMorgan.com email: kmdsi@KirbyMorgan.com



PART # 535-900 SL-17A/B Safety Pin

KMDSI recommends that the SAFETY PIN, part # 535-900 be used when ever diving the SuperLite 17 A/B helmet. This pin is inserted into the hole in the shaft of the plunger from the front. It can be used with or without a cord attached to prevent loss of the pin when not in use.



Plunger shaft hole where pin is inserted

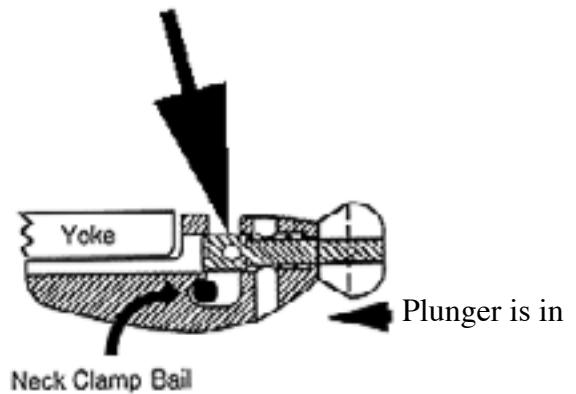

⚠ CAUTION

Use only KMDSI original replacement parts. The use of other manufacturers' parts will interfere with the performance characteristics of your life support equipment and may jeopardize your safety. Additionally, any substitutions will void any warranties offered by KMDSI. When ordering spares, always insist on Kirby Morgan Genuine Parts.