



Kirby Morgan Dive Systems, Inc.®

1430 Jason Way Santa Maria, California 93455

Phone: 805/928-7772 Fax: 805/928-0342

www.KirbyMorgan.com email: kmdsi@KirbyMorgan.com

PART #525-220 SL-27 Port Weight Kit

Parts Included:

4	530-062	Screw
2	530-070	Screw
2	530-540	Washer
1	560-081	SL-27 Port Weight Chromed

Tools Needed:

Screwdriver
Drilling Template (included in kit)
Felt Tipped Marker
Drill Motor
5/16" Drill Bit
RTV Silicone Sealant
Torque Screwdriver



1. Remove the port, port retainer and TV handle. To mount the template you will use three of the port retainer screws and three of the whisker spacers.

Note: This is a good time to inspect the Port Retainer inserts. These inserts should be in good condition, and not be loose or have cracks in the fiberglass around them.

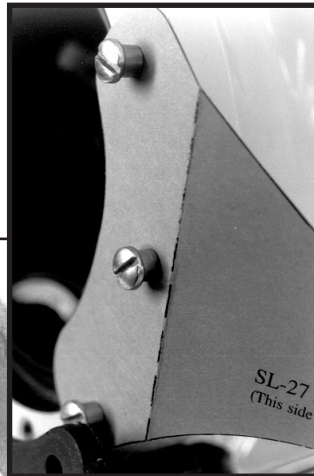

2. Using the whisker spacers on the port retainer screws, secure the drilling template in place on the port side, tightening the screws just enough to hold the template. Bend the drilling template around and onto the port side of the helmet.



Note: Once the port weight is installed, the chin weight becomes optional depending on the accessories mounted to the helmet.

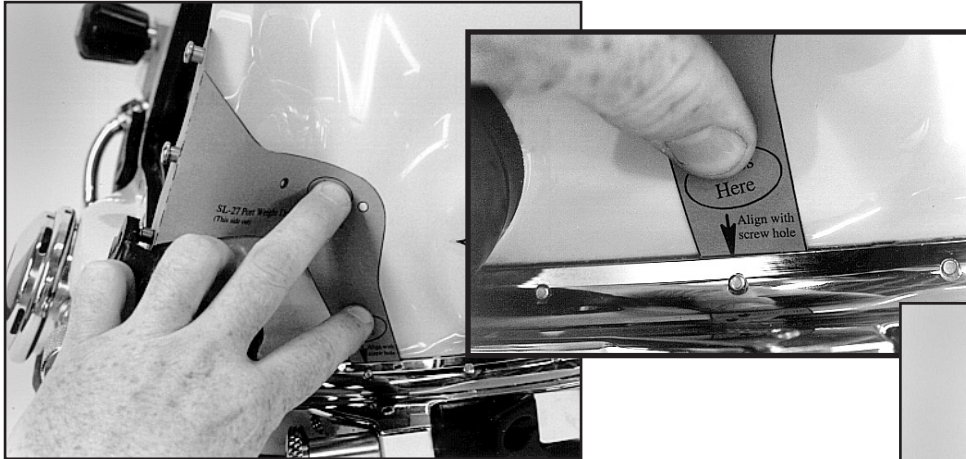

3. Make sure that bottom edge of the template is aligned with the top of the helmet ring, then take a felt tip marker and mark the location of the weight mounting holes.

4. Drill the holes using a 5/16" drill bit. Take care to clean all fiberglass residue out of the helmet.



5. Put RTV silicone sealant around the edges of the two sides and the top of the weight and around



the screw holes as shown. Secure the weight to the helmet using the screws and washers provided. Clean off the excess silicone at this time.

6. Reinstall the port and port retainer. Tighten the port retainer screws to 12 inch pounds. Put a circle of RTV sealant around the rear screw hole of the handle and reinstall the TV handle



525-220 SL-27 Port Weight Drilling Template Master

